

CNB 78

CNB

SOLARIS YACHTS SRL

Via Curiel, 49

33051 Aquileia UD Italy

Tél. : 39 (0)431 91304

cnb@cnbyachts.com

An exciting new journey for CNB !

After more than thirty years of experience with sailing yachts that have made their mark on the world of sailing, CNB is returning to its roots by joining Solaris.

This shipyard shares the same ambition, that of making unique boats resulting from rare know-how which combines craftsmanship and technology.

No change of course, the DNA of CNB remains, as evidenced by the CNB 78, incorporating all the attributes of her predecessors she is seaworthy, elegant and timeless.

This alliance between these two legendary brands will make it possible to offer even more pleasure in living at sea.

The reference point for offshore sailing boats.



The CNB 78 redefines the off-shore sailing yacht with crew. From her predecessor, she takes on the same style and functionality but now offers even brighter, larger spaces where every detail has been designed for the pleasure of being at aboard.

The aft section is the crew's domain with a professional standard galley and a chart table all integrated in the immediate vicinity of a double cabin.

The saloon is an extension of the cockpit; the glass aft bulkhead and the panoramic roof reinforce the feeling of freedom, enhanced by a subtle balance between wood, lacquered surfaces and textiles.

Guests will enjoy two double cabins of equal size, while the owner's suite is worthy of a 90 foot yacht, occupying the entire area forward of the mast. Her purposeful lines combined with a wide and powerful hull thanks to its two chines inspired by the world of ocean racing promise great performance.

The CNB 78 combines the experience of CNB and the knowhow of Solaris to create a modern and seaworthy yacht made to explore and conquer all oceans.

VINCENT ARNAUD

A handwritten signature in blue ink, appearing to read 'Vincent Arnaud', written in a cursive style.





CNB78 EXTERIOR | PHILIPPE BRIAND YACHT DESIGN



CNB78 is the successor to CNB76. It is a revolution rather than an evolution. We have kept all the criteria of the ideal yacht for voyages:

- The water-line length of less than 24 m to explore the coastal waters.
- The ability to be managed by a reduced and permanent crew.
- The forward owner's cabin and the aft garage with longitudinal annex.

Nevertheless the 78 is a brand new drawing. We introduced new ideas that were close to our hearts, following my personal and extensive navigations on the 76:

- The hull is new and has more volumes at the ends, like the latest racing prototypes.
- On the deck, the priority is the life-style of our customers facilitated by a cockpit with an «urban» design.
- Transparency is «key»: thanks to a glazed rear wall of the coachroof, the view of the living room is panoramic through 360°.

To this must be added the construction expertise of CNB's new partner, the Solaris shipyard. To voyage at sea with style and performance !!!

PHILIPPE BRIAND





**A COCKPIT FLOATING
IN THE AIR**

The geometry of the seats, the high backrests, the multiple storage compartments all make the cockpit as comfortable at anchor as when sailing.





I was particularly pleased that the Solaris group wanted to continue the specific style of the CNB's that we designed and created for the 76: this is recognition of the remarkable success of this model.

The new range, and the 78 in particular, are in the same vein: both classic and innovative, resolutely contemporary, elegant, bright, comfortable and above a joy to live with.

She benefits above all from the opportunities offered by her new hull, which has enabled us to achieve unequalled improvements in volume and perceived space, particularly in the forward part of the yacht.

All these transformations, associated with the construction quality of the Solaris shipyard and its cabinetmaking, will make this CNB the new reference point in its market.

Welcome aboard !

JEAN-MARC PIATON
CLÉMENT BERCAULT

A handwritten signature in blue ink, which appears to read "M. Piaton".

THE SALOON





THE SALOON

A BRIGHT SALOON

Seating at the perfect height for enjoying the panoramic view, the saloon to starboard has a wine cellar or a fridge and coffee machine integrated under the bookcase. The coffee table can be stored during sailing.

COMFORT AND SERENITY

Elegance, comfort and light: a spacious and elegant sofa and dining table, a layout conducive to relaxation that links the interior and the exterior.



OPTION



THE OWNER'S SUITE





THE OWNER'S SUITE

VOLUME AND REFINEMENT

A suite organized around a central bed with a bookcase on either side of the bedhead.

VAST STORAGE SPACE IN COMPLETE PRIVACY

A long console/desk provides an exceptional private workspace, which hides a large TV screen. The design gives privacy to the bedroom.

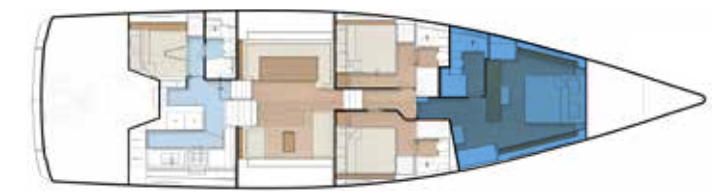

OPTION



THE OWNER'S SUITE | BED LOOKING FORWARD





THE OWNER'S SUITE BED LOOKING FORWARD

VOLUME AND REFINEMENT

A suite organized around a king size bed facing forward.

VAST STORAGE SPACE IN COMPLETE PRIVACY

Large storage units integrated into the headboard and a comfortable sofa surrounded by shelves, the ideal place to relax.

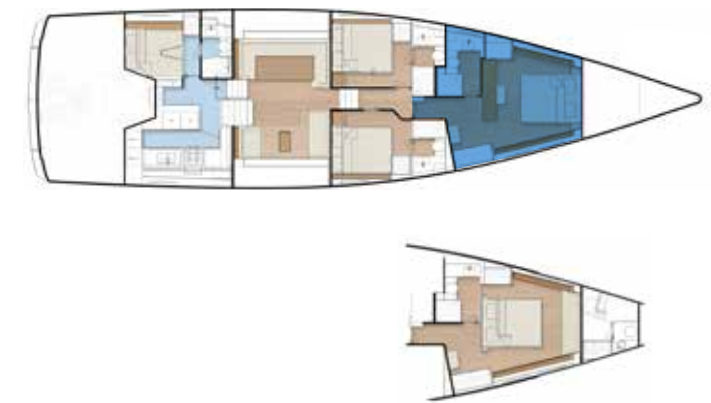

THE GALLEY





THE GALLEY

PROFESSIONAL GALLEY

Functional and user-friendly, a living space in its own right.

GALLEY

Spacious, elegant and functional under way, the galley is separated from the guest area.





SPECIFICATIONS

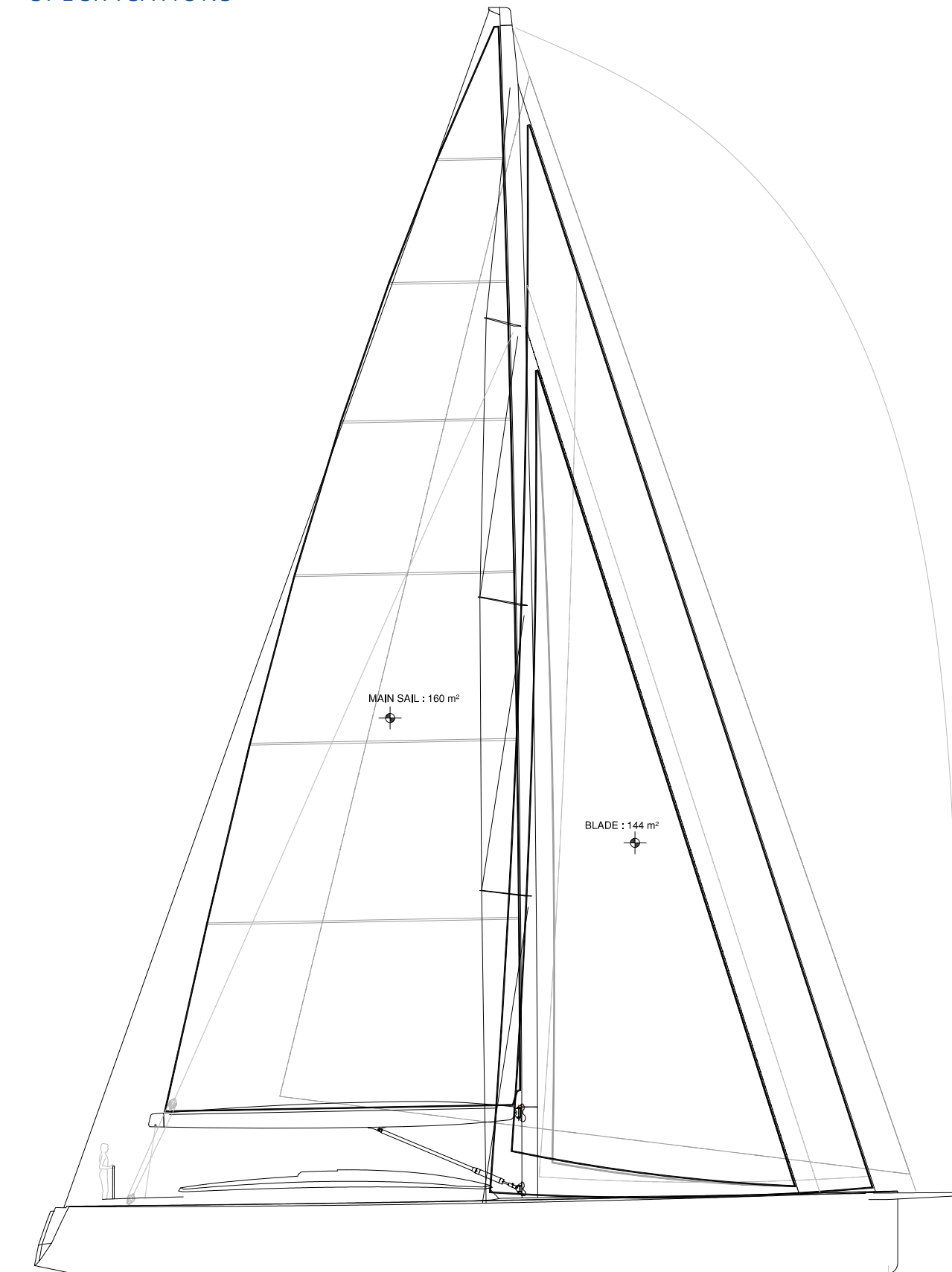

• Naval architect	Philippe Briand
• Interior design	Piaton Yacht Design
• Length overall (with bow roller)	24.85 m / 81'5"
• Hull length	23.25 m / 76'3"
• Length with bowsprit	24.85 m / 81'5"
• Length @ waterline	22.20 m / 72'8"
• Maximum beam	6.10 m / 20'
• Draught (standard)	3.50 m / 11'5"
• Light displacement MSC (approx.)	47900 kg / 105 600 lbs
• Standard keel (approx.)	12600 kg / 27 800 lbs
• I	30.00 m / 98'4"
• J	9.06 m / 29'7"
• P	29.00 m / 95'1"
• E	9.60 m / 31'5"
• Air draught (excluding aerials)	34.00 m / 111'5"
• Fully battened mainsail area (approx.)	160 m ² / 1722 ft ²
• Furling genoa area (approx.)	144 m ² / 1550 ft ²
• Staysail area (approx.)	79 m ² / 850 ft ²
• Asymetric spinnaker area (approx.)	470 m ² / 5059 ft ²
• Gennaker or Code 5 area (approx.)	405 m ² / 4359 ft ²
• Code 0 area (approx.)	235 m ² / 2529 ft ²
• Main engine	VOLVO D4 175 HP @2800rpm
• Fresh water capacity	1500 L / 396 US gal
• Fuel capacity	2500 L / 660 US gal



LAYOUTS



This document is not contractual. The illustrations of the boat featured in this brochure may include optional equipment/accessories.

Conception : Piaton et Associés
Visuels 3D : Philippe Briand & Piaton Yacht Design : Clément Bercault
Images de synthèse : Absolute 2001

CNB
YACHT BUILDERS